

we w. 972. Play 3.

Service Information

1983-08-09

Videopac computers
G7000
G7200

G83-004

GB

It may occur that the electrolytic capacitors mentioned below will no longer function well when they have not been used for more than three months. That is why they will no longer be supplied as service component. The replacing code numbers are given below:

Old	Replacement	Applied in	Item number
4822 124 20776	4822 124 21409	G7000	C207 680 μ F/16 V
4822 124 21262	4822 124 21408	G7000	C211 4700 μ F/10 V
4822 124 20776	4822 124 40199	G7200	C194 680 μ F/10 V
4822 124 21298	4822 124 21412	G7200	C200 470 μ F/40 V
4822 124 21299	4822 124 21408	G7200	C203 4700 μ F/10 V

NL

Het kan voorkomen dat de onderstaande electrolytische condensatoren niet goed meer zijn als zij langer dan 3 maanden niet gebruikt zijn.

In verband hiermee worden zij niet meer als service onderdeel geleverd.

De vervangende codenrs. zijn hieronder opgegeven:

Oud	Vervanger	Toegepast in	Pos. nummer
4822 124 20776	4822 124 21409	G7000	C207 680 μ F/16 V
4822 124 21262	4822 124 21408	G7000	C211 4700 μ F/10 V
4822 124 20776	4822 124 40199	G7200	C194 680 μ F/10 V
4822 124 21298	4822 124 21412	G7200	C200 470 μ F/40 V
4822 124 21299	4822 124 21408	G7200	C203 4700 μ F/10 V

F

Il se peut que les condensateurs chimiques dont il est question ci-dessous ne sont plus fiables après 3 mois hors d'utilisation.

Il en résulte qu'ils ne sont plus livrables comme pièces Service.

Les codes de remplacement sont donnés ci-dessous:

Ancien	Remplaçant	Monté dans	No de repère
4822 124 20776	4822 124 21409	G7000	C207 680 μ F/16 V
4822 124 21262	4822 124 21408	G7000	C211 4700 μ F/10 V
4822 124 20776	4822 124 40199	G7200	C194 680 μ F/10 V
4822 124 21298	4822 124 21412	G7200	C200 470 μ F/40 V
4822 124 21299	4822 124 21408	G7200	C203 4700 μ F/10 V

D

Nachstehend aufgeführte Elektrolytkondensatoren dürften nicht mehr brauchbar sein, wenn sie länger als 3 Monate nicht benutzt worden sind.

In diesem Zusammenhang werden sie nicht mehr als Serviceteil geliefert.

Die Ersatz-Codenummern entnehmen Sie der Tabelle:

Alt	Ersatz-kondensator	Eingebaut in	Pos. Nr.
4822 124 20776	4822 124 21409	G7000	C207 680 μ F/16 V
4822 124 21262	4822 124 21408	G7000	C211 4700 μ F/10 V
4822 124 20776	4822 124 40199	G7200	C194 680 μ F/10 V
4822 124 21298	4822 124 21412	G7200	C200 470 μ F/40 V
4822 124 21299	4822 124 21408	G7200	C203 4700 μ F/10 V

PC	S	C	F
	S	6	
		38	43 42
	C2	27 20	39
		37 68	44 33
		41 28	32 33
		58 23	
		30 36	30 17
		29 57	31
		25	17
		24	54
		22 73	
		18 21	26
		34 35	27 36
		33 39	28 40
		32	40
		78 31	29 41
		66	
		67	
		74	
		93	
		75	
		86	16
		50 90	
		88	
		87	
		26 71	
		51 69	
		47 48	35 34
		43	99
		101	
		5	5
		4	
	S1	51 100	
		94 22	6 2
		6	4
		84 2	
		92 80	3
		74 7	25
		15 83	45 46
		79 63	
		49	
		64	
		81	8
		76 95	
		97 62	
		91 98	
		16	
		7	
		96	
		59 42	11...14
		53 44	53 54
		8...13	
		52 47	
		48	
		49	
		51 50	

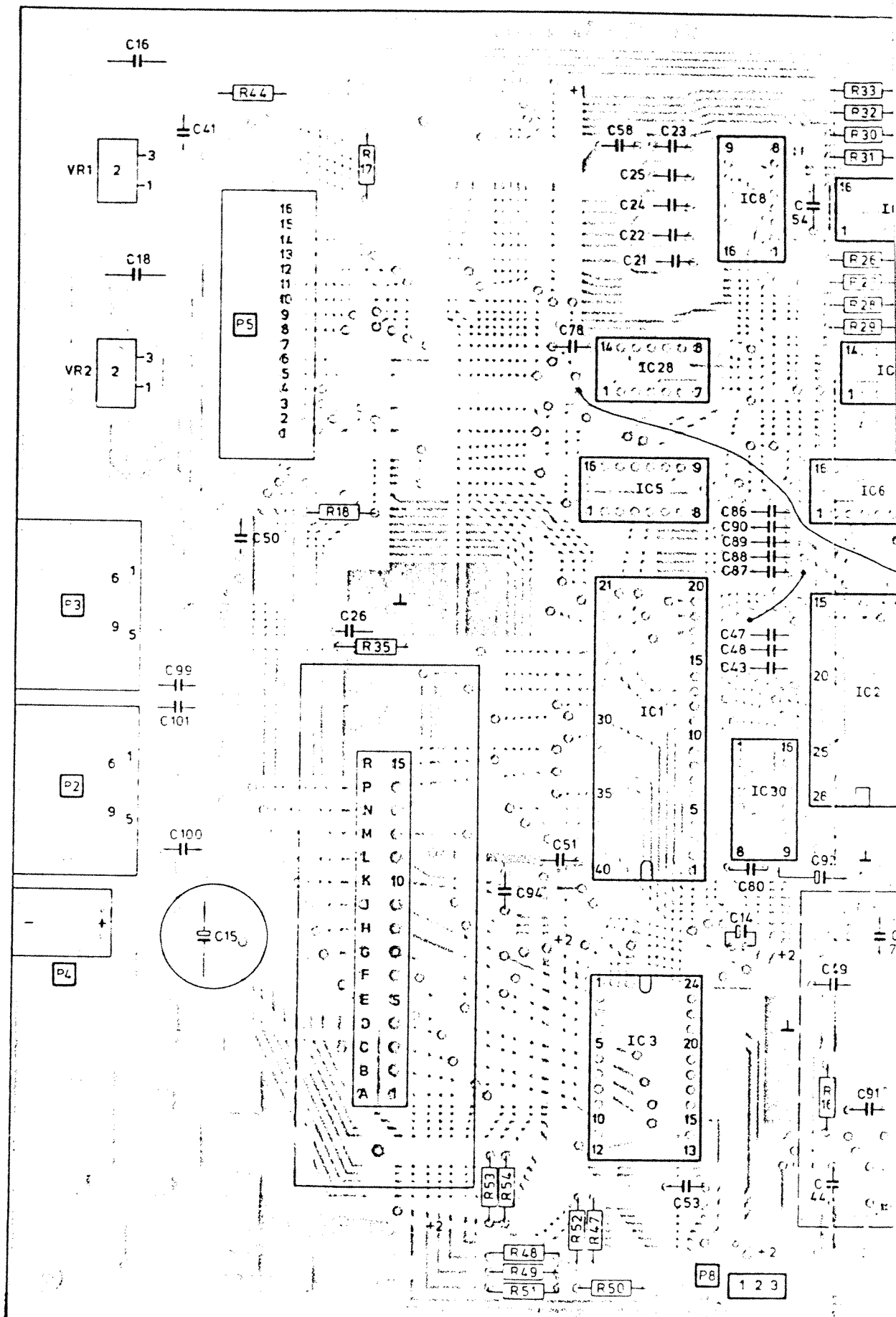

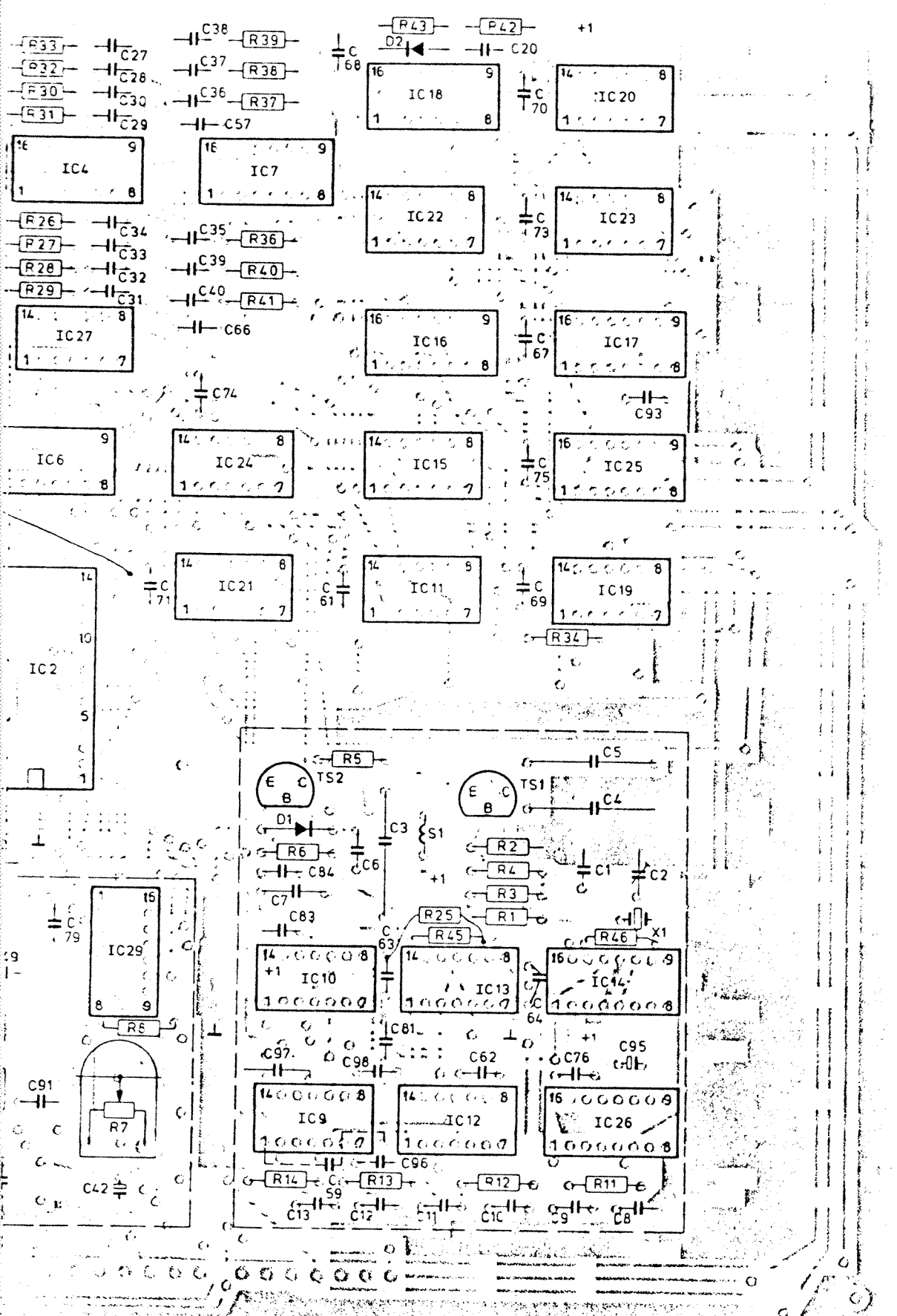

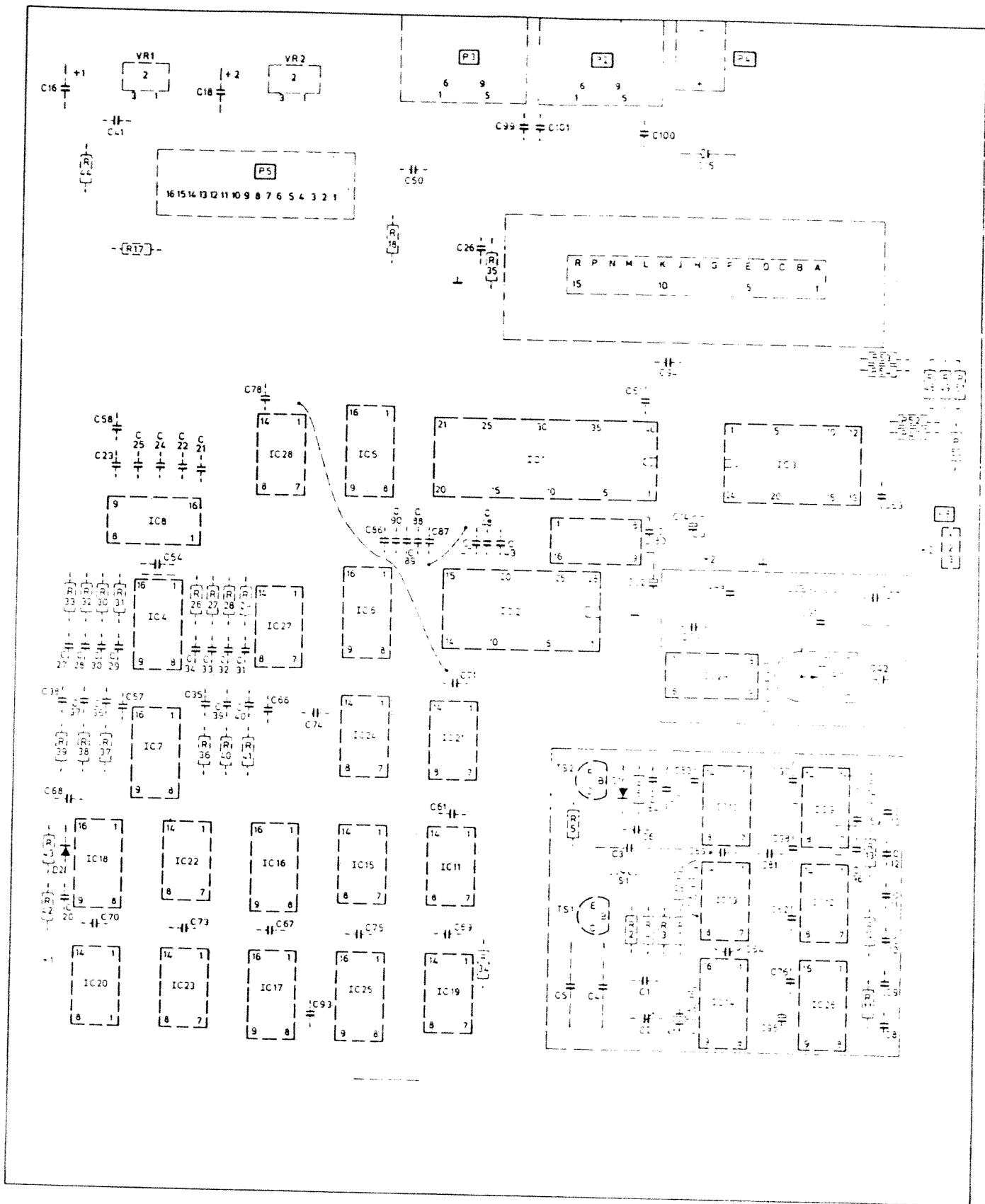

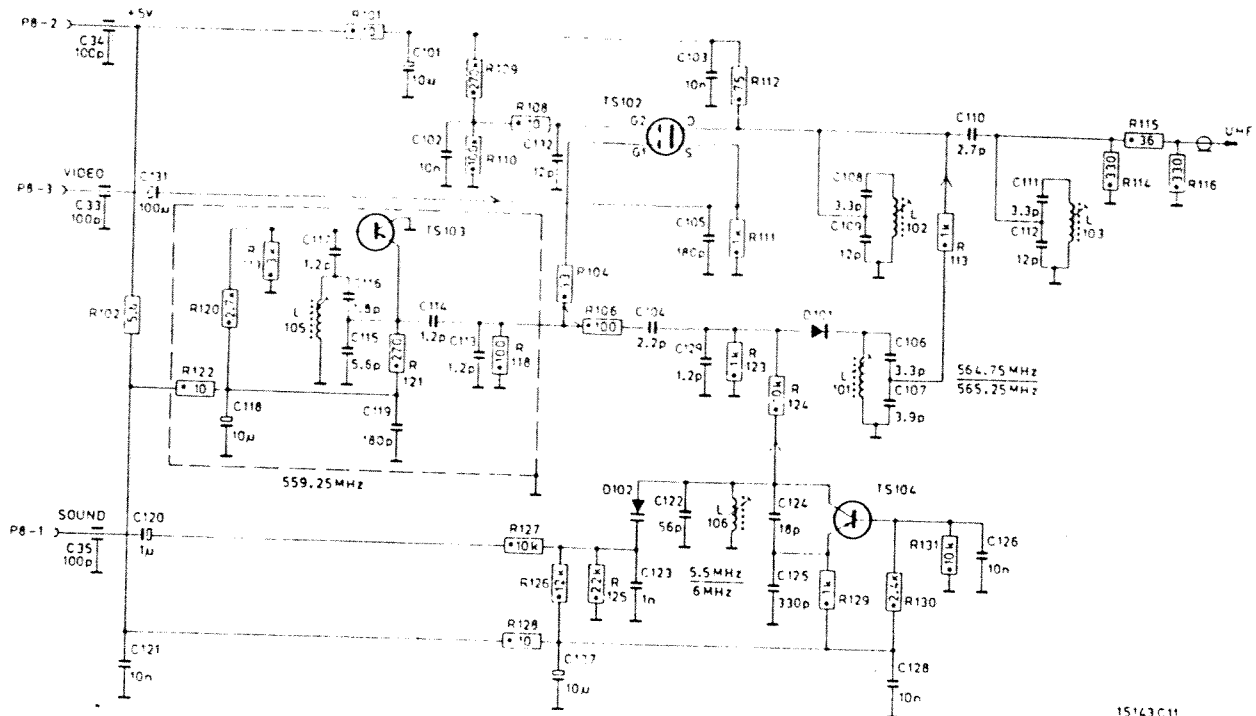

15143 C11

TS	L	C	R
D			
		130	
		131	
103		127	
104		119	
		117	
		123	
		120	
		118	
		124	
		122	
105		121	
		114	
		106	
D 102		123	
		125	
		113	
		122	
		118	
		124	
		104	
		123	
D 101		121	
		128	
		122	
		107	
		127	
		101	
		129	
		104	
		127	
		113	
		116	
		105	
102		132	
		131	
		103	
		109	
		108	
		111	
		115	
		108	
		112	
		103	
		129	
		101	
		114	
		110	
		110	
		102	

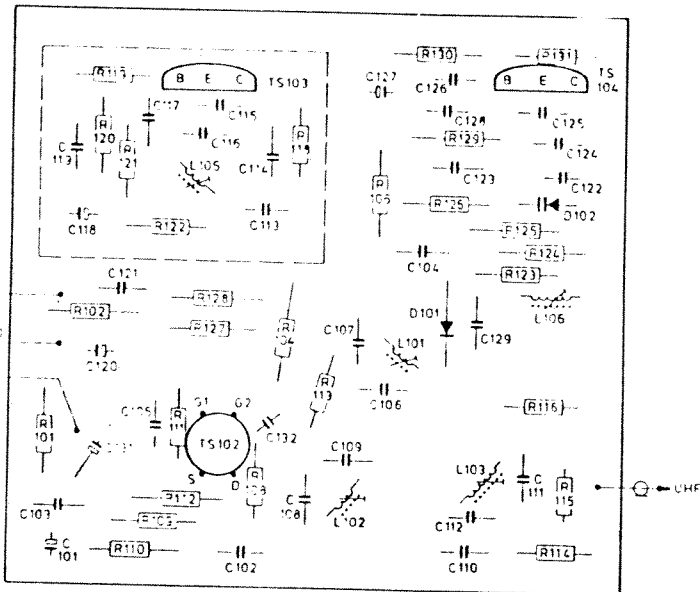

15144 C11

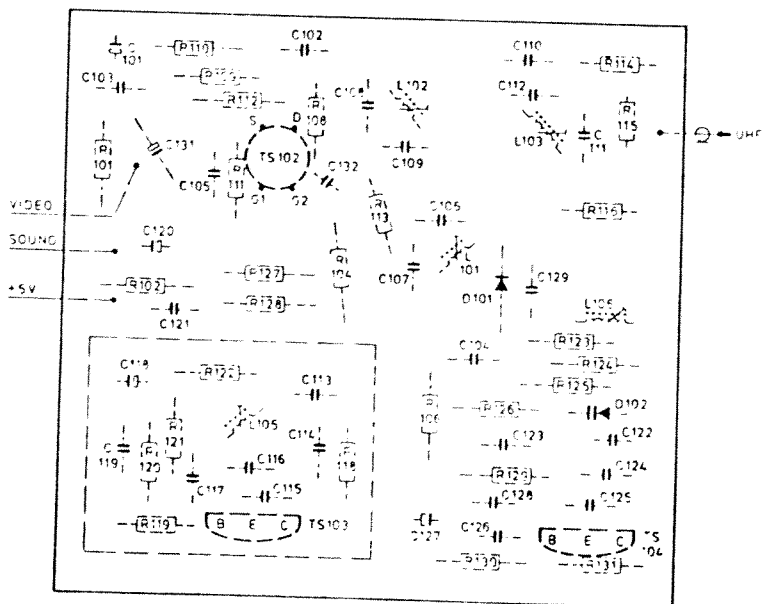

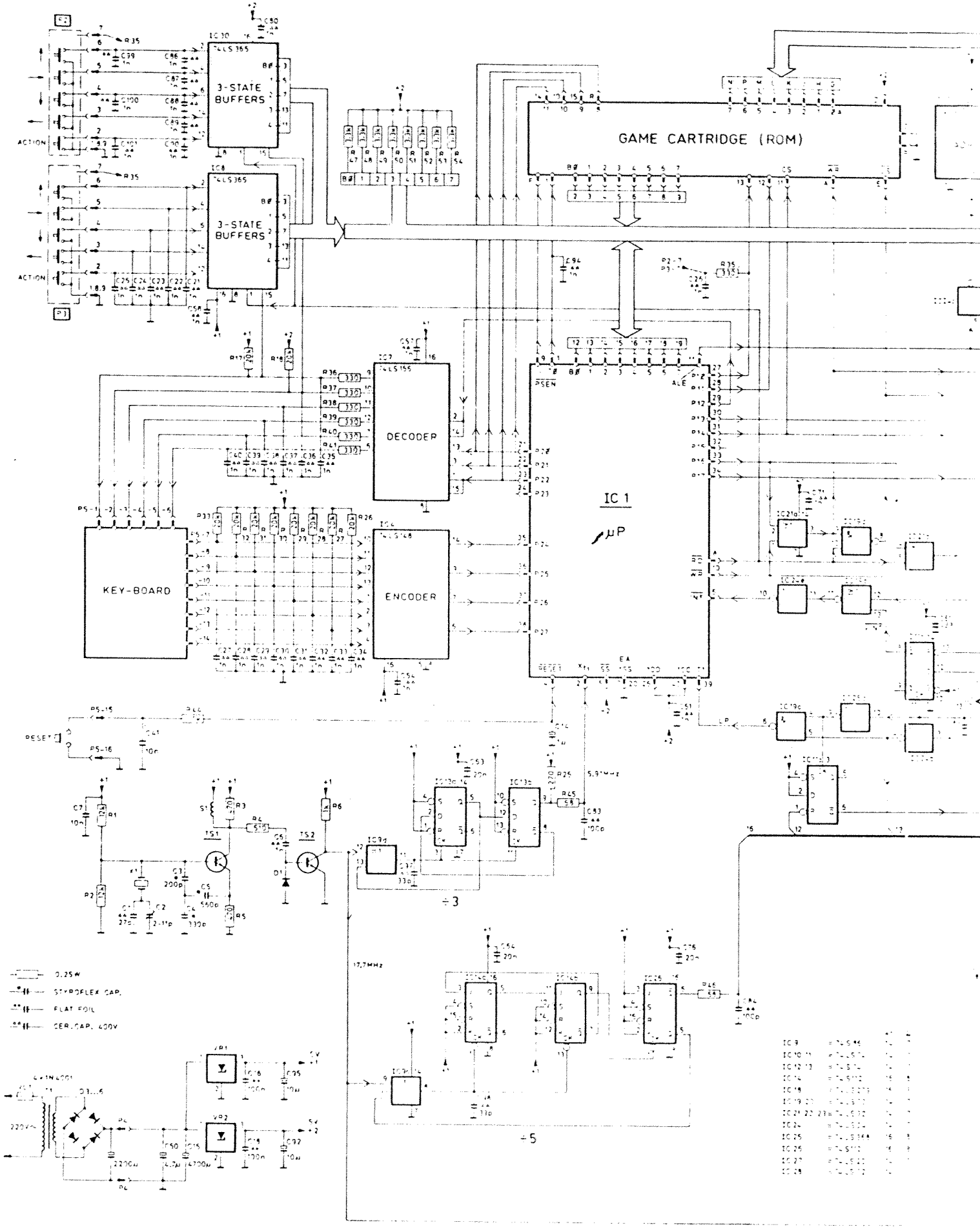

- 0.25 W
- STYPOFLEX CAP.
- FLAT FOIL
- CER. CAP. 400V

IC 9	= 74LS46	16	1
IC 10	= 74LS74	16	1
IC 12	= 74LS74	16	1
IC 14	= 74LS121	16	1
IC 18	= 74LS121	16	1
IC 19	= 74LS121	16	1
IC 21	= 74LS121	16	1
IC 22	= 74LS121	16	1
IC 23	= 74LS121	16	1
IC 24	= 74LS121	16	1
IC 25	= 74LS144	16	1
IC 26	= 74LS121	16	1
IC 27	= 74LS21	16	1
IC 28	= 74LS121	16	1

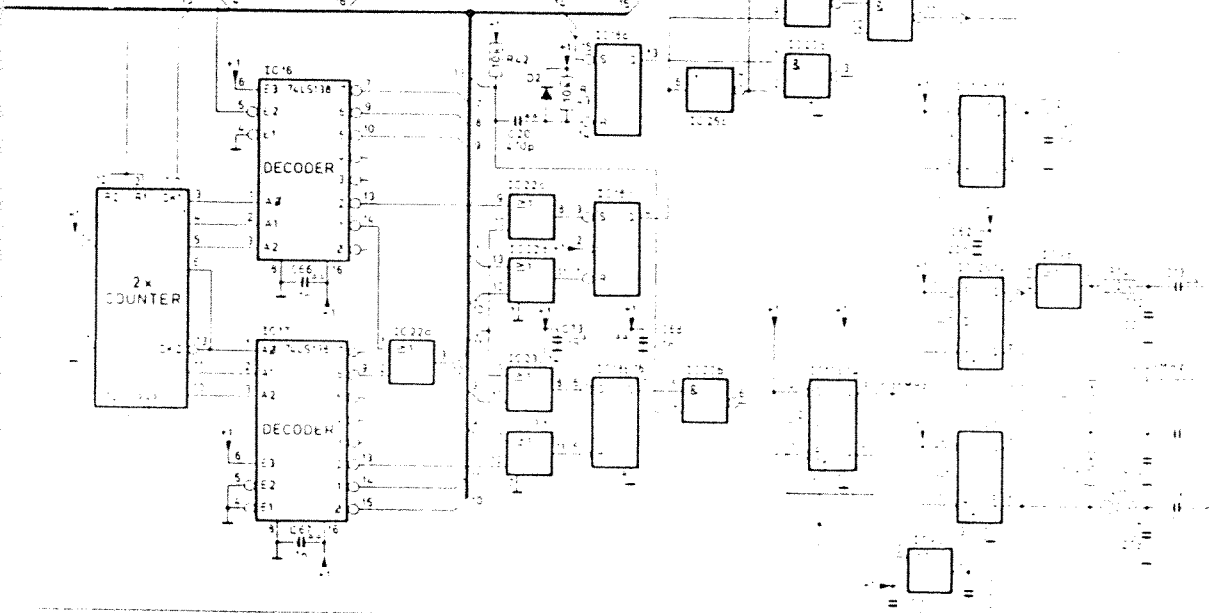
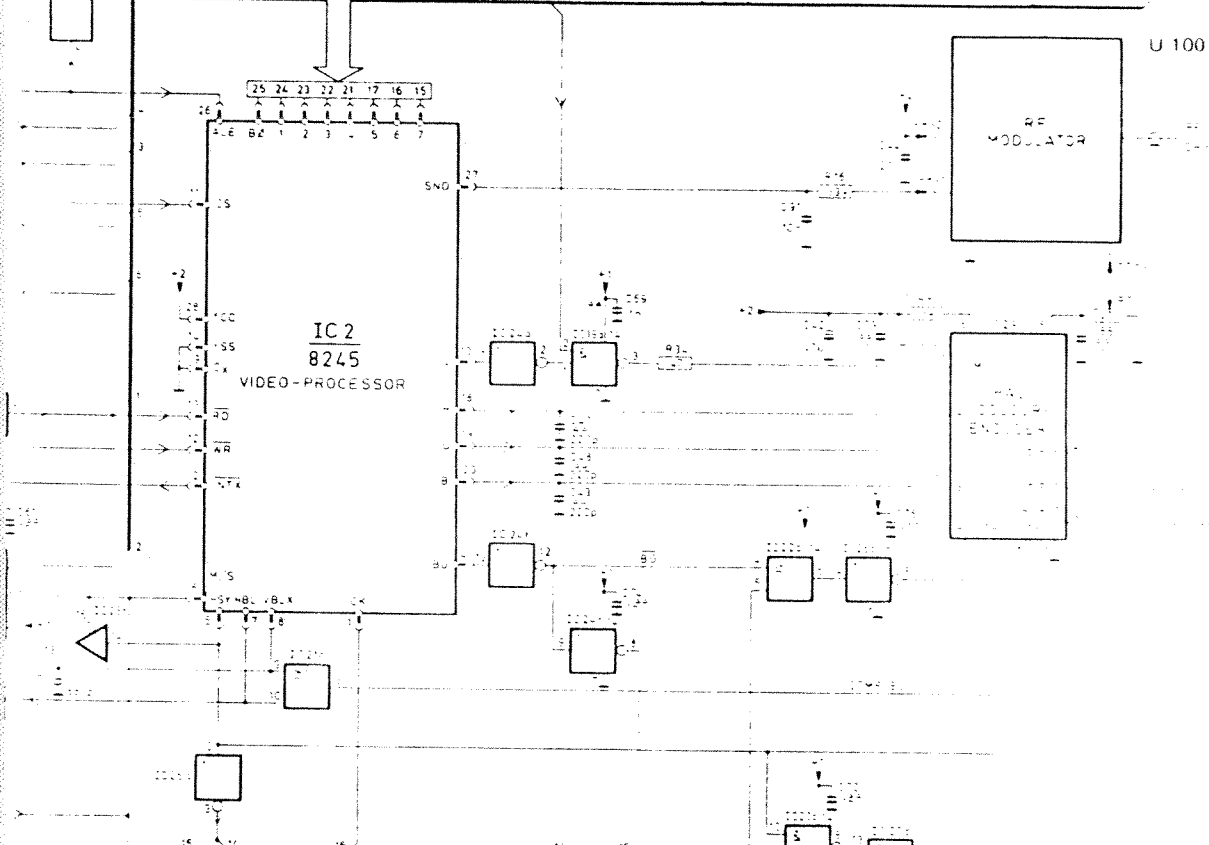
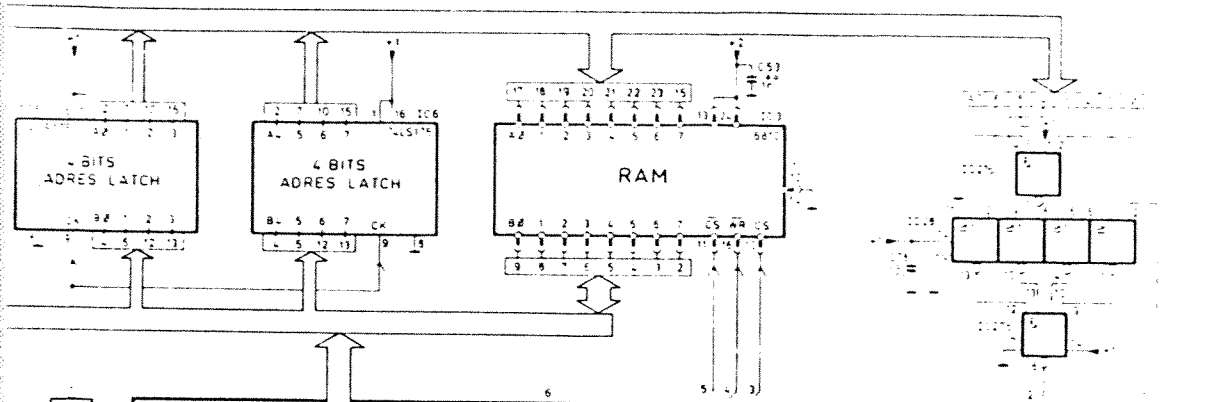

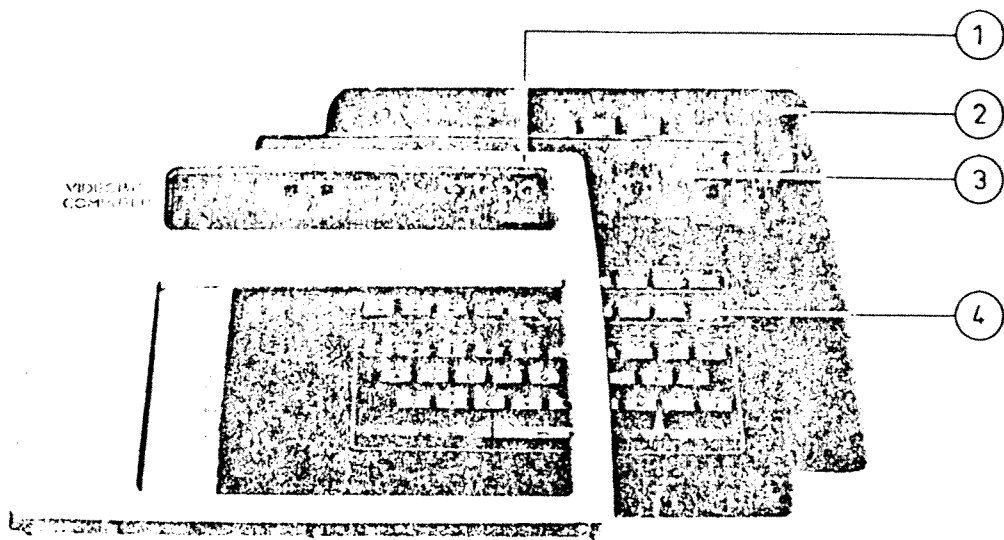

1		4822 441 80
2		4822 441 80
3		4822 441 80
4		4822 219 80
5		4822 441 80
6		4822 321 20
7	220 V~	4822 148 80
7	240 V~	4822 148 80
8	5.5 MHz	4822 210 50
8	6.0 MHz	4822 210 50
9		4822 264 30
10		4822 264 30
11		4822 267 30
12		4822 267 50
13		4822 265 40
14		4822 265 40
15		5322 255 40
16		5322 255 40
17		5322 255 40

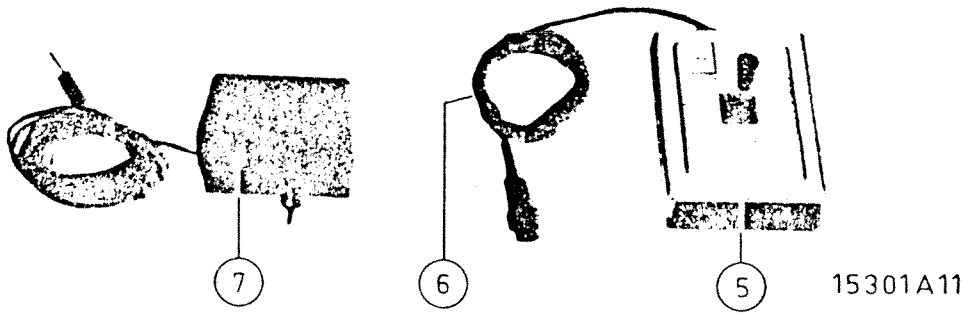



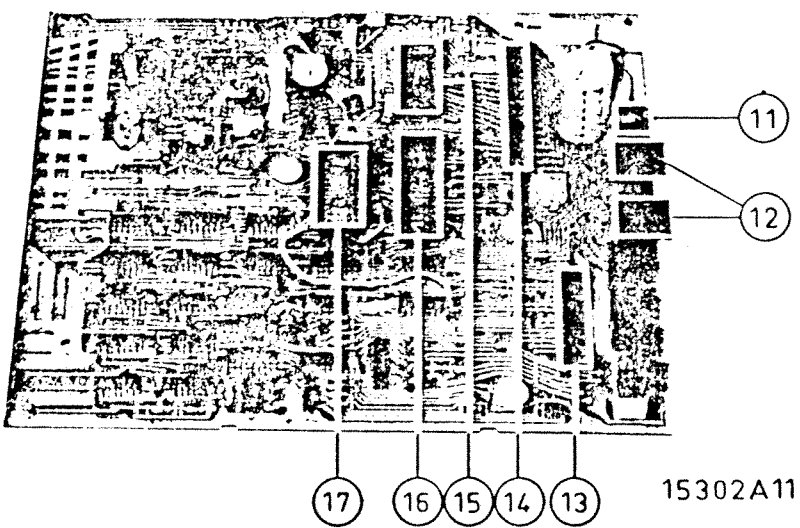
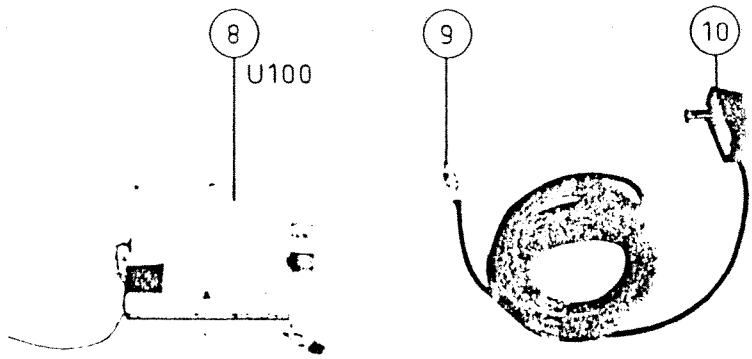

15301A11

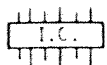

15302A11

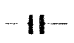
441 80282
 441 80283
 441 80284
 219 80256
 141 80285
 421 20373
 143 0026
 143 0027
 210 50085
 210 50086
 264 30039
 264 30104
 267 30304
 267 50266
 265 40137
 265 40138
 265 44171
 265 44117
 265 44047

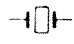
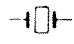
					
D1		4822 130 30998	IC1	8048/612191-1	4822 209 E
D2		4822 130 30998	IC2	8245	4822 209 E
D3	1N4001	5322 130 30197	IC3	6810	4822 209 E
D4	1N4001	5322 130 30197	*IC4	74LS148	4822 209 E
D5	1N4001	5322 130 30197	IC5	74LS175	5322 209 E
D6	1N4001	5322 130 30197	IC6	74LS175	5322 209 E
D101		4822 130 31042	IC7	74LS156	4822 209 E
D102		4822 130 31055	IC8	74LS365	4822 209 E
			*IC9	74S86	5322 209 E
TS1		4822 130 41229	-IC10	74LS74	5322 209 E
TS2		4822 130 41229	-IC11	74LS74	5322 209 E
TS102		4822 130 41234	*IC12	74S74 <i>612223-1</i>	5322 209 E
TS103		4822 130 41241	*IC13	74S74	5322 209 E
TS104		4822 130 41241	*IC14	74S112	5322 209 E
			IC15	74LS393	4822 209 E
C2	2-11 pF	4822 125 50095	*IC16	74LS138	5322 209 E
C7	10 nF	4822 122 30043	*IC17	74LS138	5322 209 E
C14	1 μF	4822 124 20822	*IC18	74LS279 <i>612231</i>	5322 209 E
C15	4700 μF	4822 124 70316	-IC19	74LS00	5322 209 E
C41	10 nF	4822 122 30043	-IC20	74LS00	5322 209 E
C42	47 μF	4822 124 20461	IC21	74LS32	4822 209 E
C44	20 nF	4822 122 30103	IC22	74LS32	4822 209 E
C50	4.7 μF	5322 124 24104	IC23	74LS32	4822 209 E
C59	20 nF	4822 122 30103	-IC24	74LS04	5322 209 E
C63	20 nF	4822 122 30103	*IC25	74LS368	4822 209 E
C64	20 nF	4822 122 30103	*IC26	74S112	5322 209 E
C76	20 nF	4822 122 30103	-IC27	74LS20	5322 209 E
C91	10 nF	4822 122 30043	*IC28	74LS02	5322 209 E
C120	1 μF	4822 124 20822	IC29	612160-3	4822 209 E
			IC30	74LS365	4822 209 E
R7	1 kΩ	4822 101 10232	VR1	LM340-5	4822 130 4
			VR2	LM340-5	4822 130 4
			X1	17.73 MHz	4822 242 7

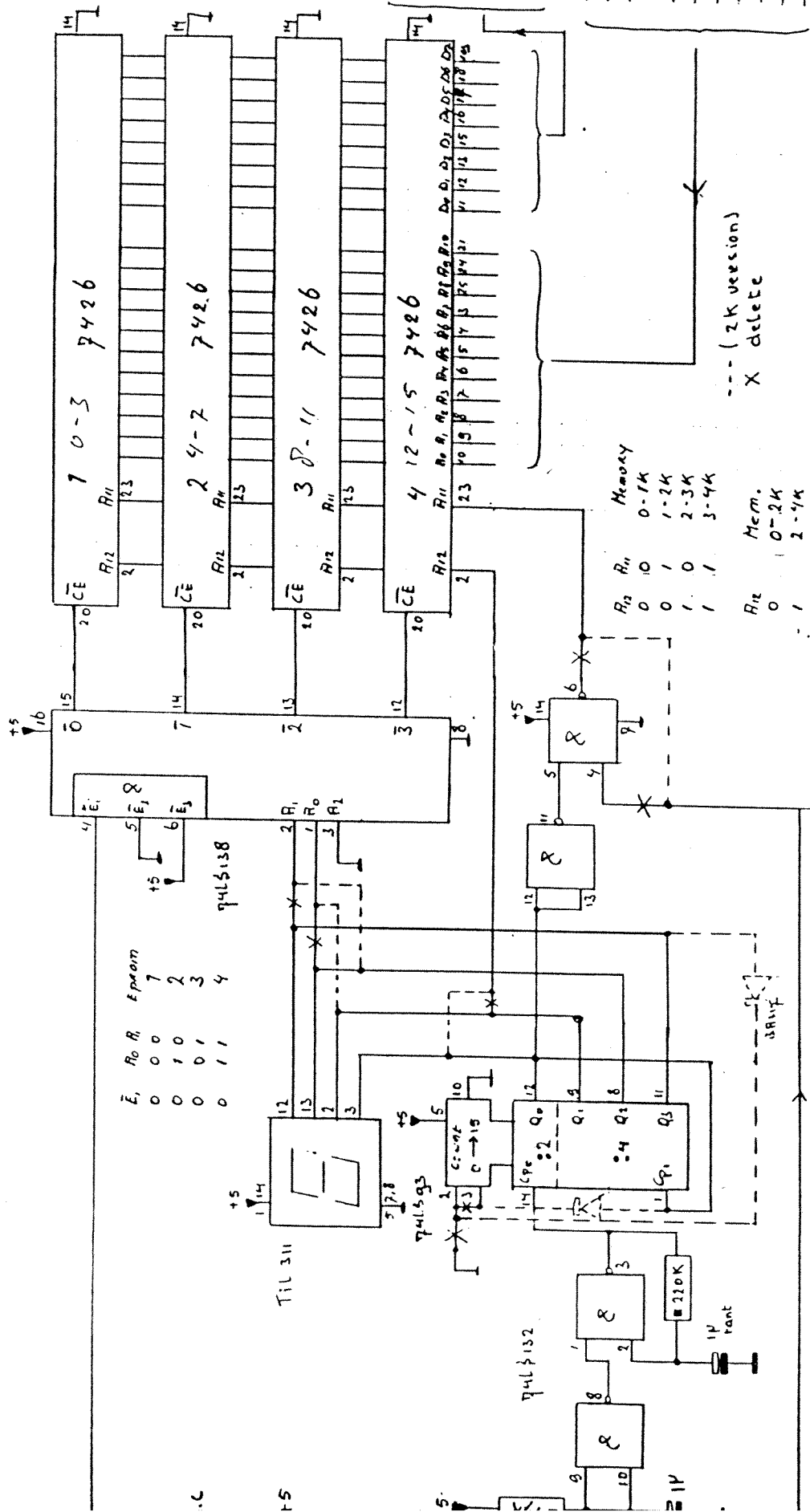

- 2 D0
- 3 D1
- 4 D2
- 5 D3
- 6 D4
- 7 D5
- 8 D6
- 9 D7
- 10 H0
- 11 H1
- 12 H2
- 13 H3
- 14 H4
- 15 M0
- 16 M1
- 17 M2
- 18 M3
- 19 R0
- 20 R1
- 21 R2
- 22 R3
- 23 R4
- 24 R5
- 25 R6
- 26 R7
- 27 R8
- 28 R9
- 29 R10
- 30 R11
- 31 R12

--- (2K version)
 X delete

X = Verbreken } voor 4x2 = 8 games van 32k
 ---- = aanbrengen

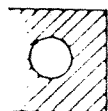

Alle rechten voorbehouden. Het is niet toegestaan deze afbeelding te kopiëren of te verspreiden. Het is niet toegestaan deze afbeelding te verspreiden of te verspreiden.

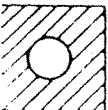

Alle rechten voorbehouden. Het is niet toegestaan deze afbeelding te kopiëren of te verspreiden. Het is niet toegestaan deze afbeelding te verspreiden of te verspreiden.

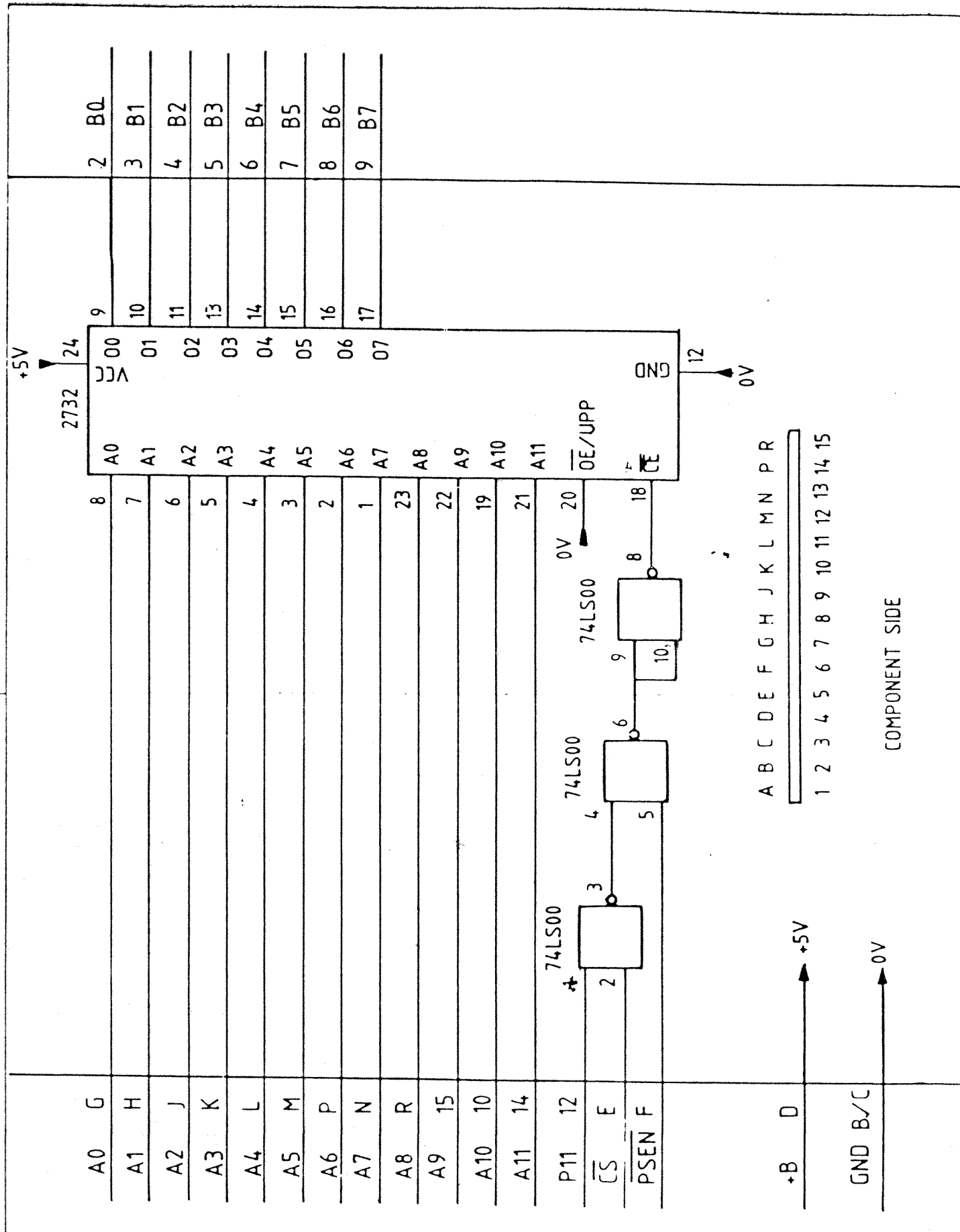

NAME NAAM	
--------------	--

97131
97140

SUPERS
VERY

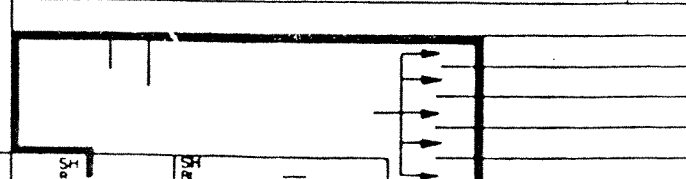

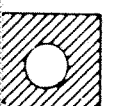
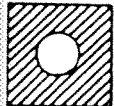

Alle rechten voorbehouden. Het is niet toegestaan dit document te kopiëren of te verspreiden. Het is niet toegestaan de inhoud van dit document te kopiëren of te verspreiden.

Alle rechten voorbehouden. Het is niet toegestaan dit document te kopiëren of te verspreiden. Het is niet toegestaan de inhoud van dit document te kopiëren of te verspreiden.

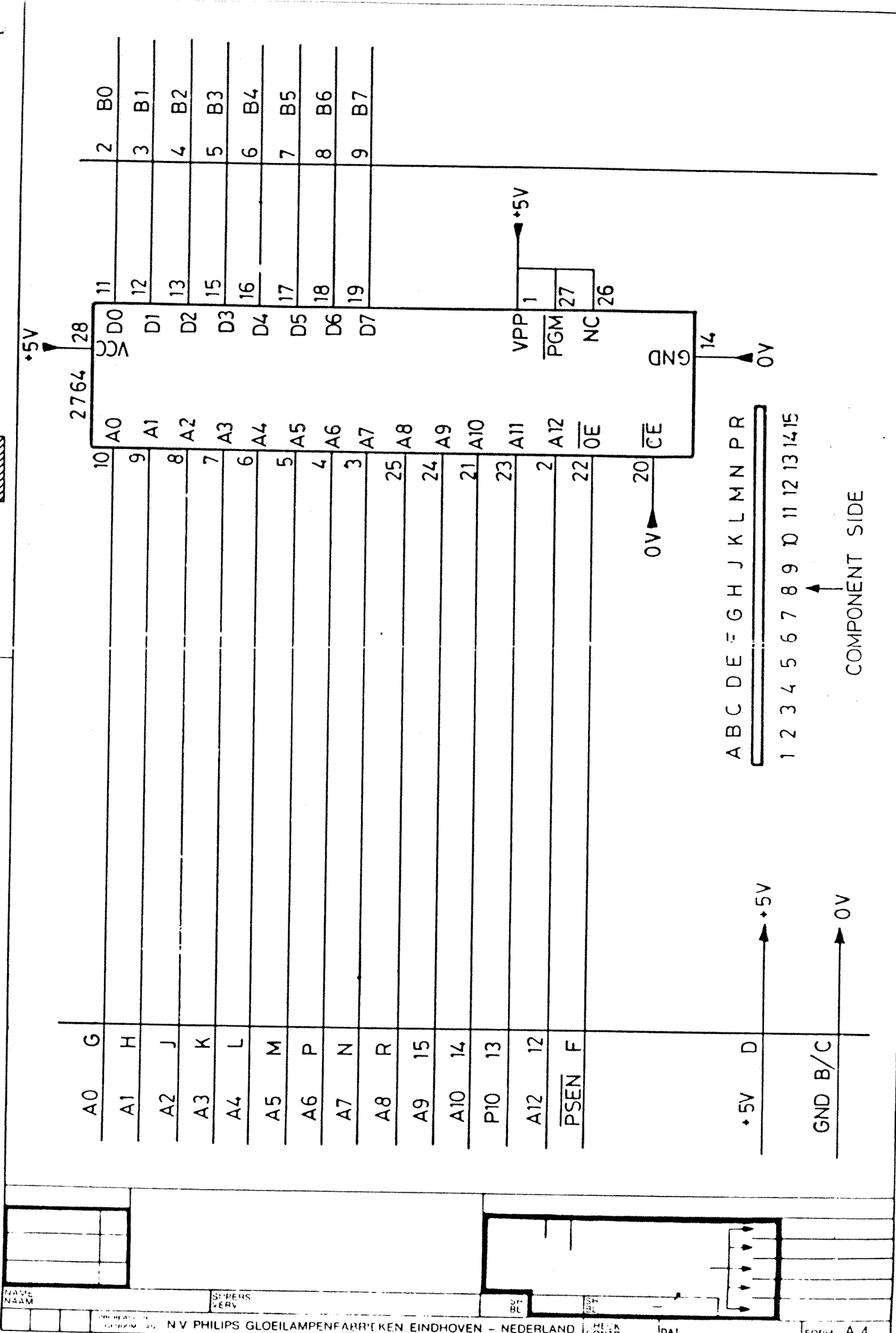
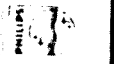

A B C D E F G H J K L M N P R
 1 2 3 4 5 6 7 8 9 10 11 12 13 14 15
 COMPONENT SIDE

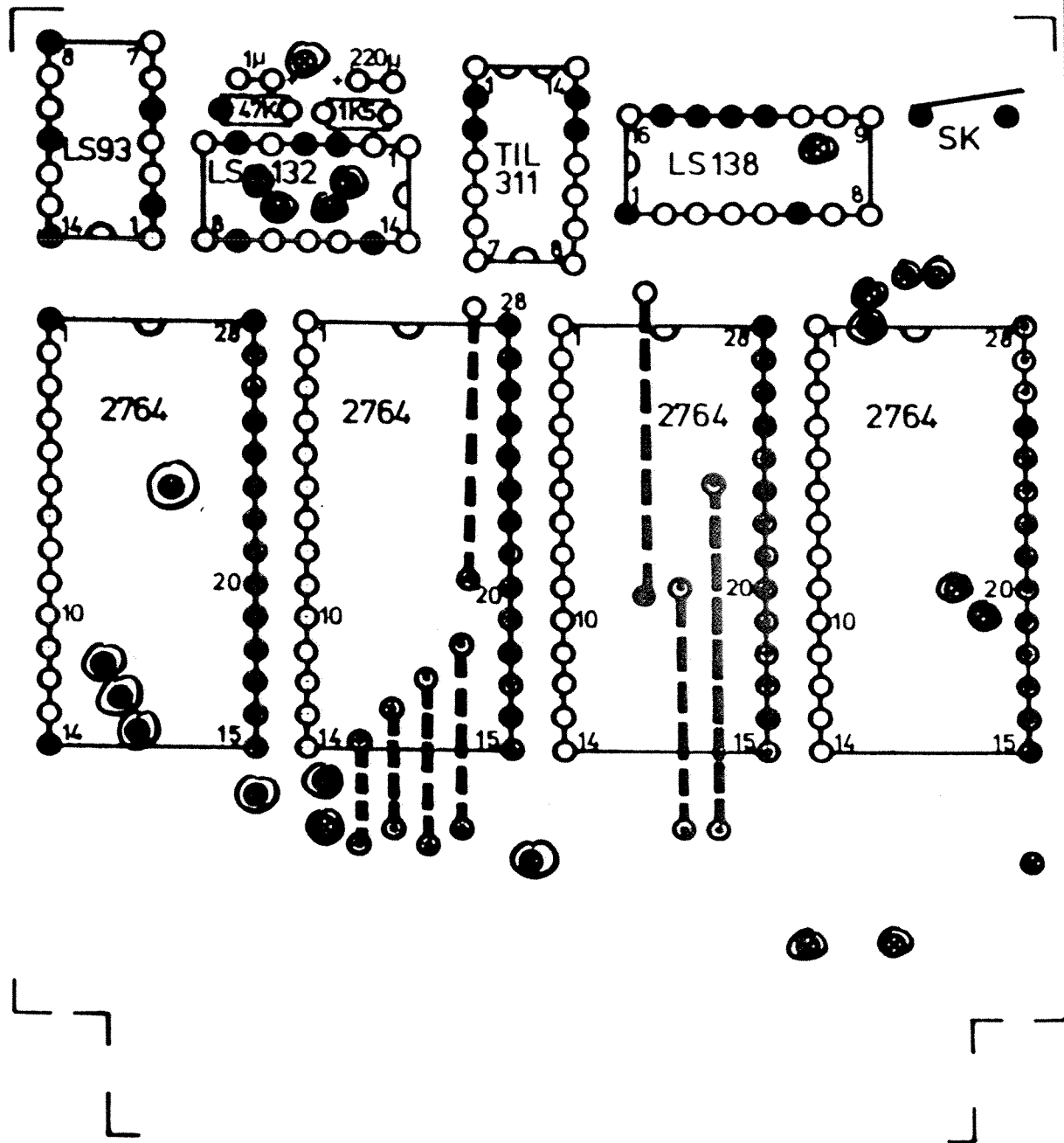

- Brugdraad
- ⊙ Doorverbinding
- Gesoldeerd aan beide zijden
- ◐ Gesoldeerd aan comp zijde

SCALE 4:1

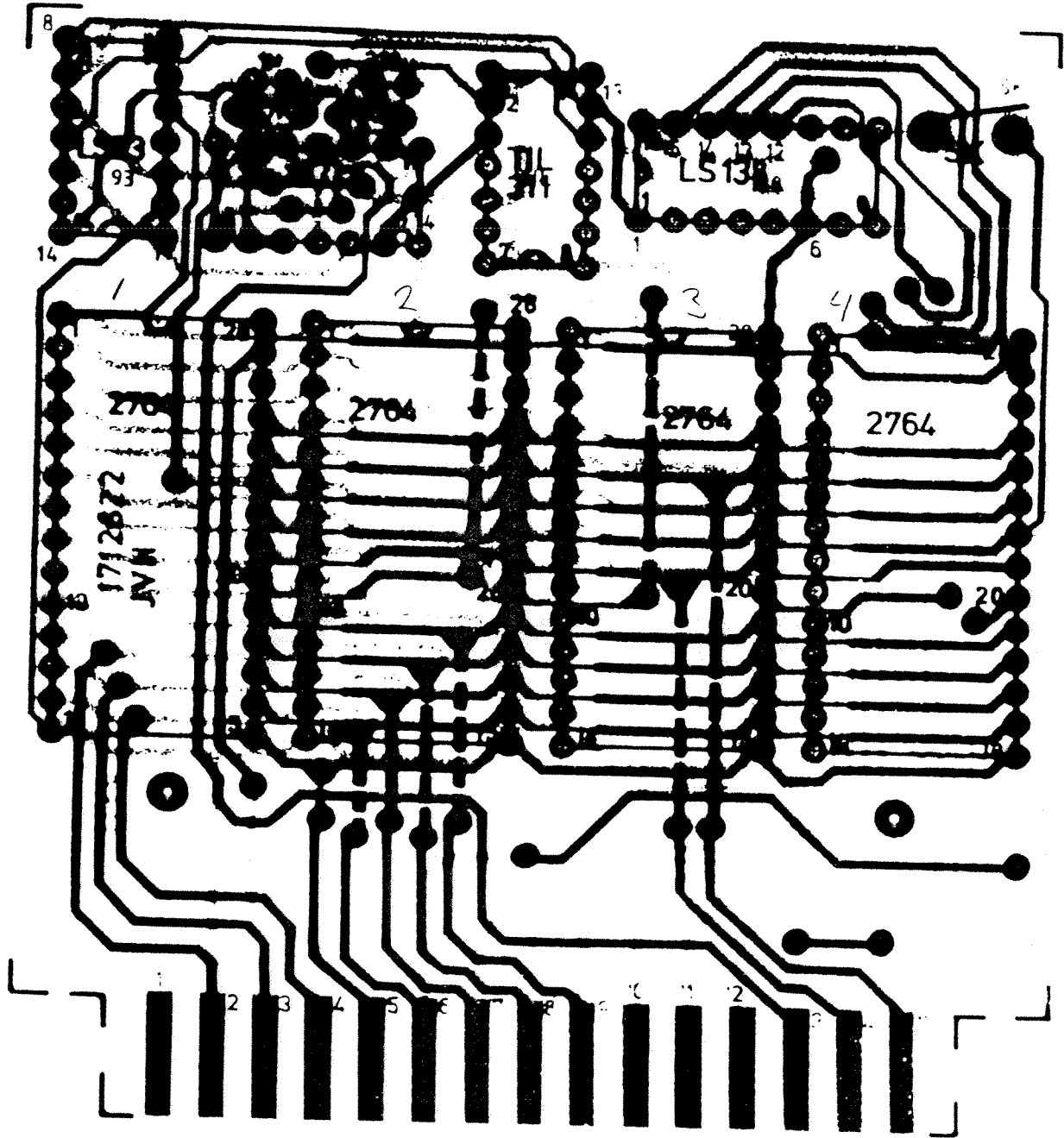

- Brugdraad
 - Doorverbinding
 - Gesoldeerd aan beide zijden
 - Gesoldeerd aan comp zijde
- Kart a

elektuur infokaart 75

μ-computer-IC's 3

EPROM's gegevens

type	kapaciteit
2708	1024 x 8 bits
2716	2048 x 8 bits
2732	4096 x 8 bits
2764	8192 x 8 bits
2516	2048 x 8 bits
2532	4096 x 8 bits

Interne organisatie van 2716

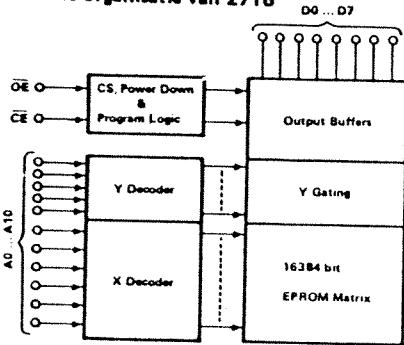

Aansluitingen

- VCC = +5 V
- VBB = -5 V
- VDD = +12 V
- Vpp = +5 V normale werking
+25 V bij programmeren
- A₀ ... A_n = adres-ingangen
- D₀ ... D₇ = data in- en uitgangen
- CS = Chip Select
- CE = Chip Enable
- OE = Output Enable
- PD = Power Down

A12 = PEN 12 VAN CONN.

elektuur infokaart 76

μ-computer-IC's 4

EPROM's aansluitingen

